

Technical Data Gas Extraction Device GED ECO



Fig. 1 Gas Extraction Device GED ECO

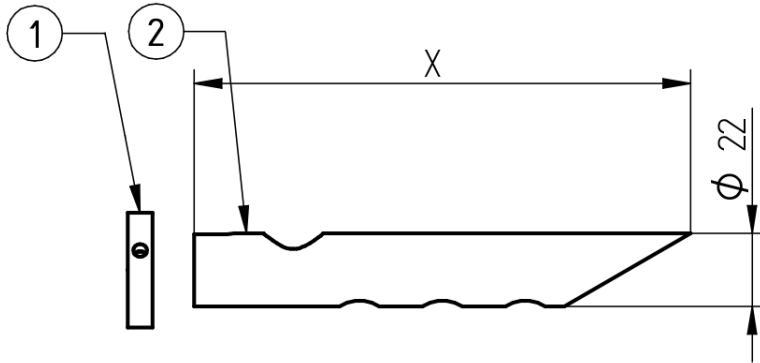

Fig. 2 GED ECO with locking ring (required for mounting)

No.	Description	Order-No.
1	Locking ring for GED ECO	655R1021
2	Gas extraction device GED ECO length X = 150 mm 5.91" in	655R1001
	Gas extraction device GED ECO length X = 300 mm 11.81" in	655R1002
	Gas extraction device GED ECO length X = 450 mm 17.72" in	655R1003

Technical Data	
Diameter	22 mm 0.87" in
Length	150 mm 5.91" in 300 mm 11.81" in 450 mm 17.72" in
Material	stainless steel 1.4571/1.4404
Weight	0.065 kg - 150 mm length 0.14 lb - 5.91" in length 0.140 kg - 350 mm length 0.31 lb - 13.78" in length 0.215 kg - 450 mm length 0.47 lb - 17.72" in length
Using	in combination with KS1D-ECO or LS2-ECO

Operating conditions	
Dust exposure	< 100 mg/m ³
Flow velocity	< 100 °C: 1 ... 6 m/s < 212 °F: 3.28 ... 19.69 ft/s > 100 °C: 1 ... 12 m/s > 212 °F: 3.28 ... 39.37 ft/s

Environmental conditions		
Operation	permissible flue gas temperature	≤ 300 °C 572 °F at probe head
Degree of protection	according to DIN EN 40050	IP 42

NOTICE

The limits of the technical data must be strictly adhered to.

Technical Data Gas Extraction Device GED ECO

Order Information

GED ECO - Application up to 300 °C | 572 °F

Designation /Type	Order-No.
Gas extraction device GED ECO, length 150 mm 5.91" in	655R1001
Gas extraction device GED ECO, length 300 mm 11.81" in	655R1002
Gas extraction device GED ECO, length 450 mm 17.72" in	655R1003

The information in this publication is subject to technical changes.



**LAMTEC Meß- und Regeltechnik
für Feuerungen GmbH & Co. KG**

Josef-Reiert-Straße 26

D-69190 Walldorf

Telefon: +49 (0) 6227 6052-0

Telefax: +49 (0) 6227 6052-57

info@lamtec.de
www.lamtec.de

